

PLUS - Static Preparation 1400 mm Sink Unit with 1 Bowl - Left drain

ITEM # _____
 MODEL # _____
 NAME # _____
 SIS # _____
 AIA # _____



134065 (GLG1416SXE)

Sink unit, with 1 bowl
(500x600x300mm) and left-
hand drainer, 1400mm

Short Form Specification

Item No.

Enhanced stability and solid construction thanks to the welded frame and legs. The 50mm high worktop in 304 AISI stainless steel, with Scotch Brite finishing 10/10 mm in thickness, has anti-drip edges, welded corners and overflow rim along the top. Welded and polish sink bowl in 304 AISI stainless steel supplied with overflow pipe and 2" drain hole. Upstand h=100mm with 10mm radius corner covered on the back with AISI 304 stainless steel spot welded profile. Square section legs and height adjustable feet (-20/+30 mm) in 304 AISI stainless steel.

Main Features

- Enhanced stability and solid construction. Stability, loading and stress tests by external certified body.
- Product range suitable for international tenders requirements for intense usage installations.

Construction

- Welded frame and legs.
- Worktop with 50mm high profile, is in stainless steel Scotch Brite finishing, 10/10 in thickness with anti-drip edges and welded corners and overflow rim along the top.
- Constructed entirely in 304 AISI stainless steel.
- Sink bowl is sound-deadened, in polish stainless steel overflow pipe and 2" drain hole.
- Drainers are sound-deadened with stainless steel reinforcement bars.
- Upstand back completely covered with Stainless Steel welded profile.
- Square section legs (40x40mm, 10/10 in thickness) and height-adjustable feet (-20/+30mm).
- Accessories:-set of castors as alternative to the feet, can be fitted as optional.

Optional Accessories

- Double plastic drain syphon 2 " for sinks PNC 850022 ☐
- - NOT TRANSLATED - PNC 855309 ☐
- - NOT TRANSLATED - PNC 855376 ☐
- - NOT TRANSLATED - PNC 855377 ☐
- - NOT TRANSLATED - PNC 855379 ☐
- Single plastic drain syphon 2 " for sinks PNC 895313 ☐

APPROVAL: _____

Key Information:

| | |
|------------------------------|--------------|
| External dimensions, Width: | |
| 134065 (GLG1416SX E) | 1400 mm |
| External dimensions, Depth: | 700 mm |
| External dimensions, Height: | 1000 mm |
| Upstand Dimensions, Height: | 100 mm |
| Upstand Dimensions, Depth: | 13 mm |
| Upstand Dimensions, Radius: | R=10 |
| Bowls number | 1 |
| Bowl dimensions | 600x500xH300 |
| Worktop thickness: | 50 mm |
| Net weight: | 35 kg |

Front

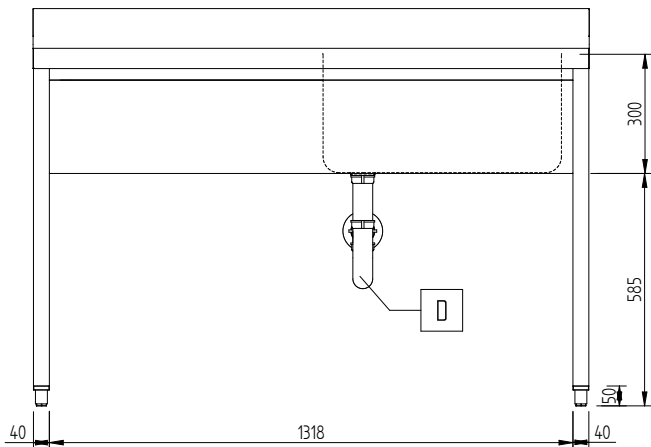

Side

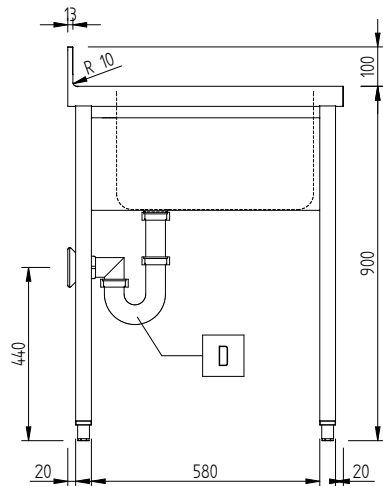

Top

